

This is a representation for leasing purposes only
and should not be used for measurements of any kind.
This drawing is not to scale.



MCKENZIE PROFESSIONAL CENTRE

1555/1595 MCKENZIE AVENUE
VICTORIA, BC V8N 1A4

GROUND FLOOR

| UNIT # | SQ FT | TENANT |
|--------|-------|------------------------------|
| 100 | 562 | Digital Rabbit Cellular |
| 101 | 773 | University Heights Pharmacy |
| 103 | 1,208 | Gordon Head Treatment Centre |
| 104 | 329 | McKenzie Barber Styling |
| 105 | 1,255 | Biotech Dental Laboratory |
| 106 | 1,188 | National Hearing Services |
| 107 | 676 | Macropus Global |
| 108 | 1,605 | Langford Sushi |
| 110 | 874 | Oshio Acupuncture Clinic |
| 111 | 498 | Six Factors Fitness |
| 112 | 857 | Tony Jiang's Beauty Salon |
| 113 | 1,767 | Available |
| 114 | 736 | Available |
| 116 | 885 | Victoria Natural Healing |
| 119 | 3,697 | Saanich Dental Group |

BASEMENT (NOT SHOWN)

| UNIT # | SQ FT | TENANT |
|--------|-------|-------------------------------------|
| B-10 | 1,257 | Westcoast Medical Imaging (Storage) |

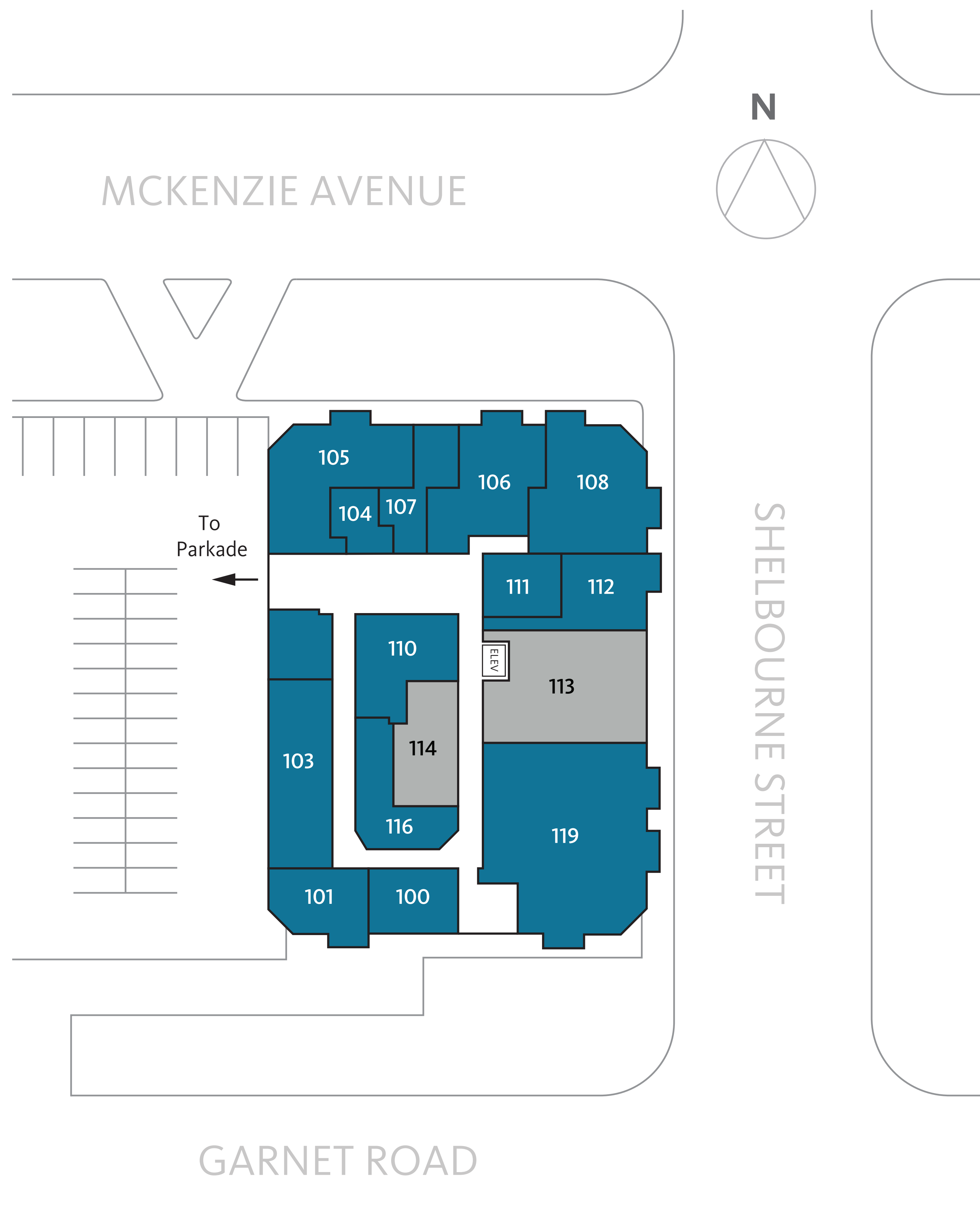

This is a representation for leasing purposes only and should not be used for measurements of any kind. This drawing is not to scale.

| | |
|---|--|
|  | <p>MCKENZIE PROFESSIONAL CENTRE 1595 MCKENZIE AVENUE VICTORIA, BC V8N 1A4</p> |
|---|--|

GROUND FLOOR

| UNIT # | SQ FT | TENANT |
|--------|-------|--|
| 200 | 688 | Dr. Keith McQueen |
| 201 | 978 | Daren J. Anton CPA |
| 202 | 1,698 | Noah Layne Academy of Realist Art |
| 203 | 1,440 | Oxford Learning Centre |
| 204 | 586 | Sunny Education |
| 205 | 984 | Dr. Chris Morgan |
| 206 | 1,484 | Dr. Elizabeth Watt & Dr. Joan Chen |
| 207 | 1,286 | Progressive Chiropractic |
| 209 | 581 | Dr. James Church |
| 210 | 718 | Rexall Drugstore |
| 211 | 925 | Dr. Roger Johnson Shelbourne Travel & Preventative Health Clinic |
| 212 | 500 | Ayase Immigration Consultants |
| 213 | 400 | Available |
| 214 | 680 | Koi Treatment Centre |
| 218 | 568 | Fastgo Express |
| 220 | 825 | Dr. Robert Shepherd |
| 222 | 1,574 | Peace of Mind Care |

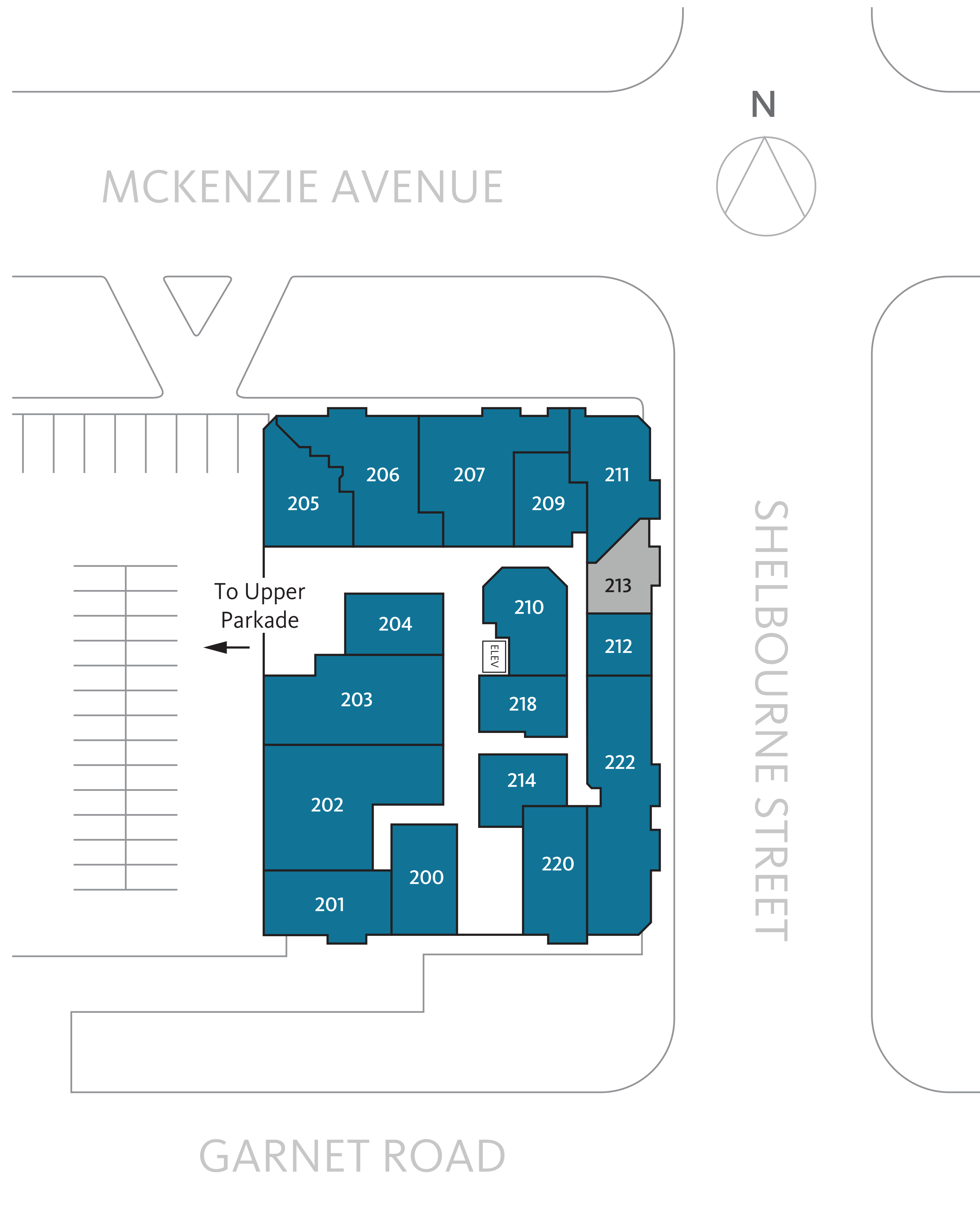

This is a representation for leasing purposes only and should not be used for measurements of any kind. This drawing is not to scale.



MCKENZIE PROFESSIONAL CENTRE
1595 MCKENZIE AVENUE
VICTORIA, BC V8N 1A4

1ST LEVEL

| UNIT # | SQ FT | TENANT |
|--------|-------|--|
| 125 | 1,922 | Tangram Culture Academy |
| 130 | 3,635 | Island Deaf & Hard of Hearing Centre |
| 135 | 1,010 | Progressive Edge Plus Training & Wellness Centre |

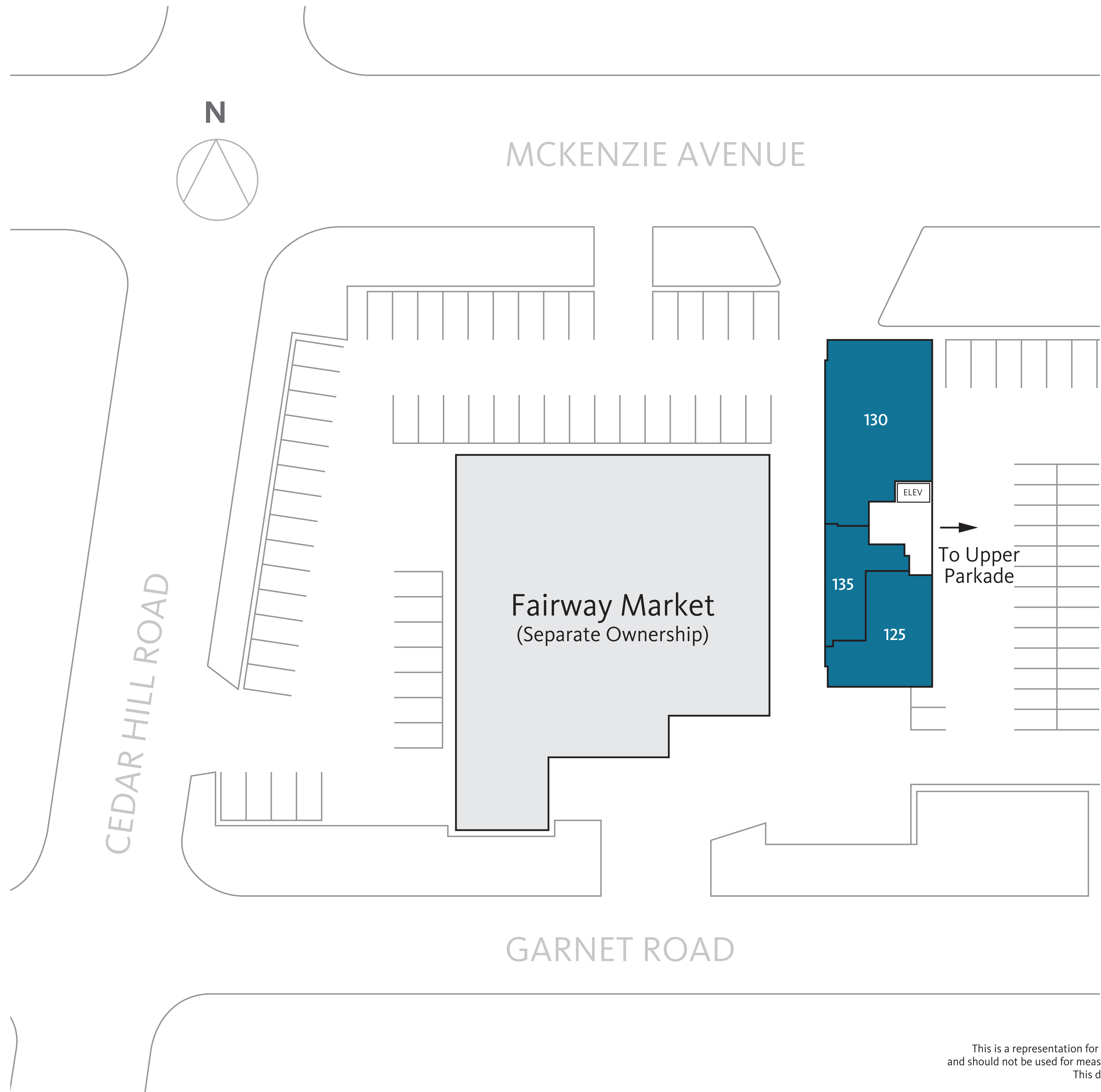

This is a representation for leasing purposes only and should not be used for measurements of any kind. This drawing is not to scale.

| | |
|---|--|
|  | <p>MCKENZIE PROFESSIONAL CENTRE 1555 MCKENZIE AVENUE VICTORIA, BC V8N 1A4</p> |
|---|--|

2ND LEVEL

| UNIT # | SQ FT | TENANT |
|--------|-------|----------------------------------|
| 230 | 1,612 | Dr. Bao Tang & Dr. Bradley Amson |
| 240 | 1,376 | Song Academy |
| 250 | 1,410 | Dr. B R. Kruger Inc |
| 275 | 2,024 | Lifemark Physiotherapy |

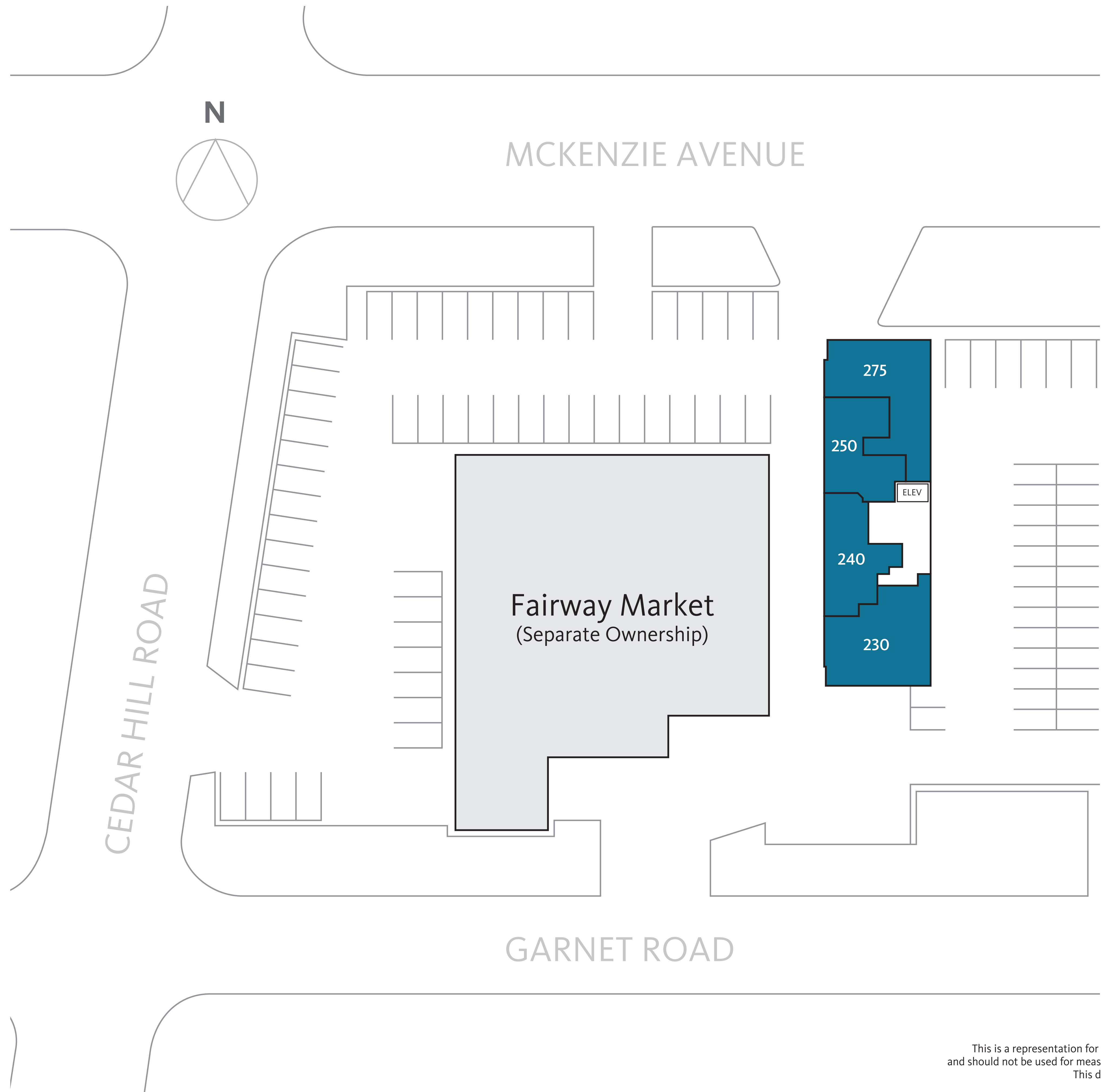

This is a representation for leasing purposes only and should not be used for measurements of any kind. This drawing is not to scale.

| | |
|---|--|
|  | <p>MCKENZIE PROFESSIONAL CENTRE 1555 MCKENZIE AVENUE VICTORIA, BC V8N 1A4</p> |
|---|--|